



PDCD

25

045

01

3

3

Pompa Türü
Pump Type

Pompa Tipi
Pump Type

Pompa Debisi
Displacement

Mil Tipi
Shaft Type

Kapak Bağlantı Deliği
Mounting Holes

Dönüş Yönü
Rotation

Pompanın Türü / Pump Type

- PDCD : Çift Dönüştü Dişli Pompa / **Bi Rotatonal Gear Pumps**
PDTDK : K Serisi Dişli Pompa / **K Series Gear Pumps**
PDTD : Tek Dönüştü Dişli Pompa / **Single Rotatonal Gear Pumps**
PDTDT : Tandem Dişli Pompa / **Tandem Gear Pumps**
PED : Pistonlu Pompa / **Piston Pumps**
PEX7 : Eksenel Pompa / **Bent Axis Pump**

Pompanın Tipi / Pump Type

- 25 : 25 Serisi Dişli Pompa / **25 Series Gear Pumps**
30 : 30 Serisi Dişli Pompa / **30 Series Gear Pumps**
35 : 35 Serisi Dişli Pompa / **35 Series Gear Pumps**
40 : 40 Serisi Dişli Pompa / **40 Series Gear Pumps**
09 : 9 Pistonlu Pompa / **9 Piston Pumps**
06 : 6 Pistonlu Pompa / **6 Piston Pumps**
52 : 7 Pistonlu Pompa / **7 Bent Axis Piston Pump**

Pompanın Debisi / Displacement

- 015 - 025 - 035 - 045 : 15 - 25 - 35 - 45 litre / **15 - 25 - 35 - 45 liters**
043 - 051 - 055 - 065 - 082 : 43 - 51 - 55 - 65 - 82 litre / **43 - 51 - 55 - 65 - 82 liters**
075 - 085 - 090 - 105 - 125 : 75 - 85 - 90 - 105 - 125 litre / **75 - 85 - 90 - 105 - 125 liters**
063 - 073 - 087 - 109 - 133 - 151 : 63 - 73 - 87 - 109 - 133 - 151 litre / **63 - 73 - 87 - 109 - 133 - 151 litres**
050 - 060 - 080 : 50 - 60 - 80 litre / **50 - 60 - 80 litres**

Mil / Shaft

- 00 : Milsiz / **Without Shaft**
01 : 8 Frezeli Mil / **8 Traillet Shaft**
02 : 6 Frezeli Mil / **6 Traillet Shaft**
03 : Kama Düz / **Wedge Straight**
04 : Kama Konik / **Tapered Wedge**

Kapak Bağlantı Deliği / Mounting Holes

- 0 : UNI
3 : ISO
5 : K Serisi / **K Series**

Dönüş Yönü / Rotation

- 0 : Sağ Dönüştü / **Clockwise (CW)**
2 : Sol Dönüştü / **Anticlockwise (CCW)**
3 : Çift Dönüştü / **Bi-Rotatonal**



Eksenel Pistonlu Pompa Bent Axis Piston Pumps

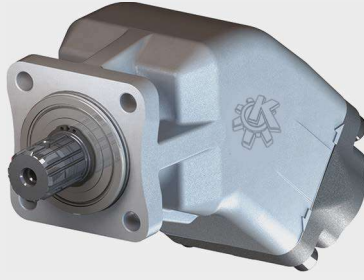
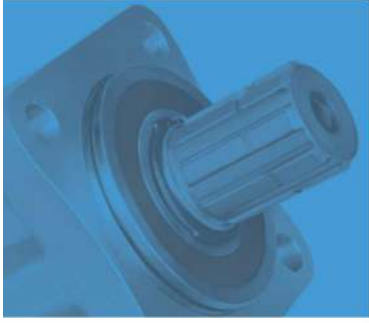

Pompa Tipi Okuma Diyagramı | Type Reading Diagram

PEX7	-	52	-	035	-	1	-	3	-	1
Eksenel Pistonlu Pompa Bent Axis Pump		Eksenel 7 Pistonlu Pompa 7 Bent Axis Pump		Pompa Debisi Displacement		Mil Tipi Shaft Type DIN 5462 ISO		Bağlantı Tipi Mounting holes		Dönüş Yönü Rotation

Teknik Çizim | Technical Drawing

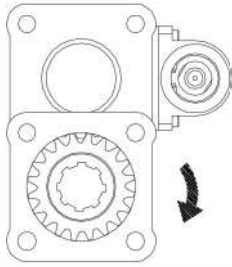

PTO Mili saat yönünde (SAĞ)
The PTO shaft is CW rotating

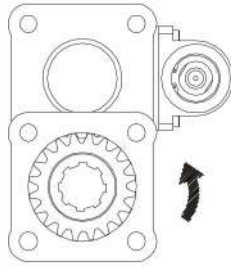

PTO Mili saatin tersi yönünde (SOL)
The PTO shaft is CCW rotating



saat yönünün tersi dönüş
CCW Rotational



saat yönündeki dönüş
CW Rotational

Basınç Tanımı | Pressure Definition

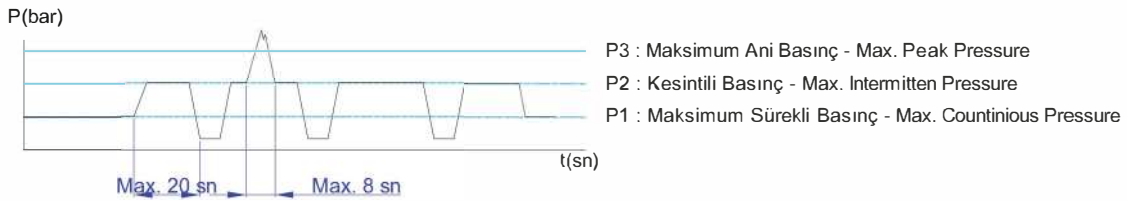

Pompa Tipi Pump Type	Debi Displacement	Max. Sürekli Hız Max. Speed at Continuous Press.	Maksimum Kesik Hız Max. Speed at Intermittent Press.(nmax)	Min Kesik Hız Min. Speed at Intermittent Press.	Max Sürekli Basınç Max. Continuous Pressure (Pnom)	Max. Kesik Basınç Max. Intermitten Pressure (Pmax)	Max. Pik Basınç Max. Peak Pressure (Pmax)
	lt/min	n (min ⁻¹) (≤ P1)	n (min ⁻¹) (P ≤ 30 bar)	n (min ⁻¹)	bar	bar	bar
35 lt	35	2200	2800	300	400	430	450
45 lt	45	2100	2500	300	400	430	450
55 lt	55	2000	2400	300	400	430	450
65 lt	65	2000	2400	300	400	430	450
85 lt	85	1800	2200	300	375	400	430
105 lt	105	1700	2100	300	350	380	400



CW

ürün kodu | product code

PEX752 035 055 085 045 065 105 131

ürün kodu | product code

PEX752 035 055 085 045 065 105 132

CCW

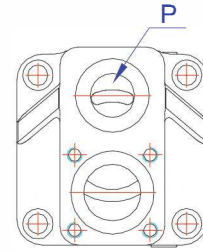
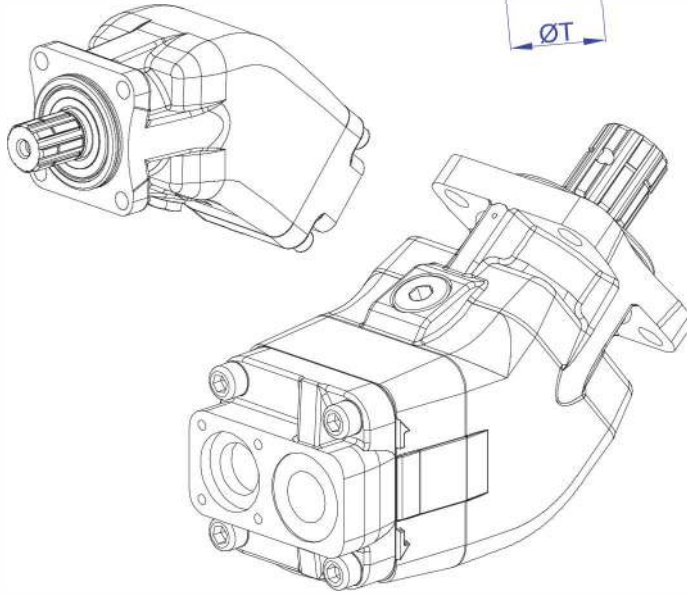
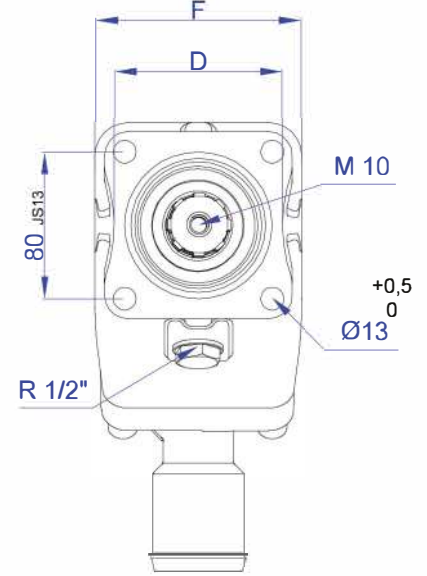
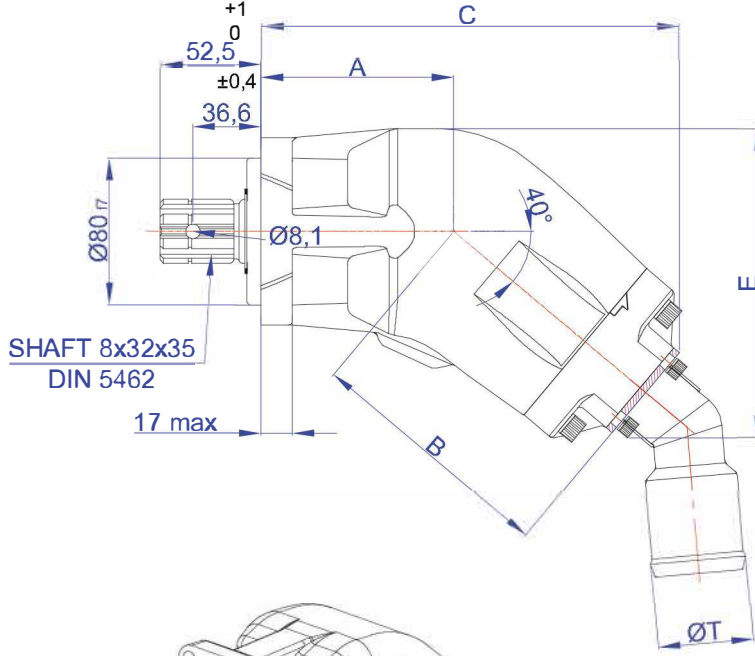

Pompa Tipi Pump Type	Pompa Kodu Pump Code	A (mm)	B (mm)	C (mm)	D (mm)	E (mm)	F (mm)	T (mm)	P (mm)	Ağırlık (kg) Weight
35 lt	PEX752035131/132	104	119	216	92,5	155	102	Ø38	R3/4"	8,3
45 lt	PEX752045131/132	104	119	216	92,5	155	102	Ø38	R3/4"	8,3

Pompa Tipi Pump Type	Pompa Kodu Pump Code	A (mm)	B (mm)	C (mm)	D (mm)	E (mm)	F (mm)	T (mm)	P (mm)	Ağırlık (kg) Weight
55 lt	PEX752055131/132	105	133	230	93	171,5	112	Ø50	R3/4"	10,5
65 lt	PEX752065131/132	105	133	230	93	171,5	112	Ø50	R3/4"	10,5

Pompa Tipi Pump Type	Pompa Kodu Pump Code	A (mm)	B (mm)	C (mm)	D (mm)	E (mm)	F (mm)	T (mm)	P (mm)	Ağırlık (kg) Weight
85 lt	PEX752085131/132	109,5	144,1	248	98	187	117	Ø63,5	R1"	13,5
105 lt	PEX752105131/132	109,5	144,1	248	98	187	117	Ø63,5	R1"	13,5



Eksenel Pistonlu Pompa Bent Axis Piston Pumps

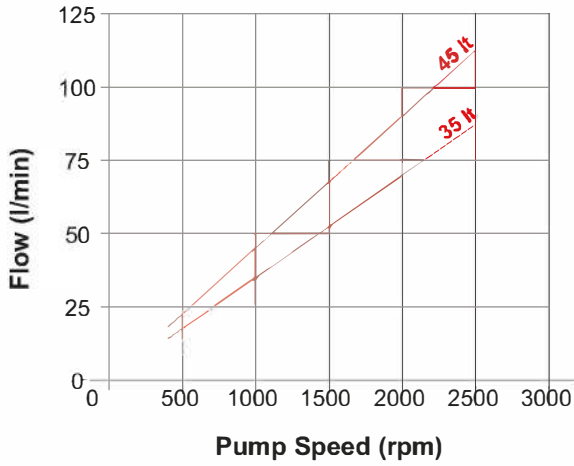

35-45 LT

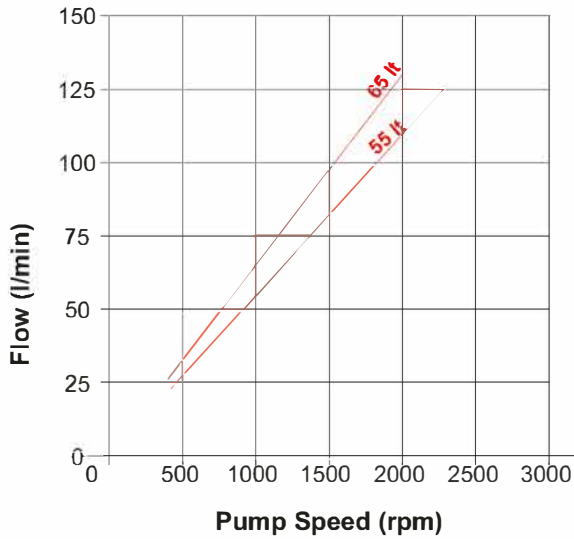
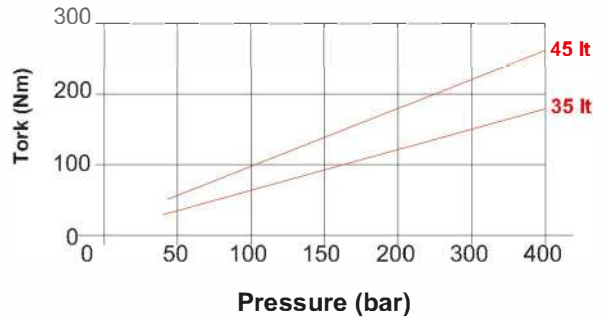

55-65 LT

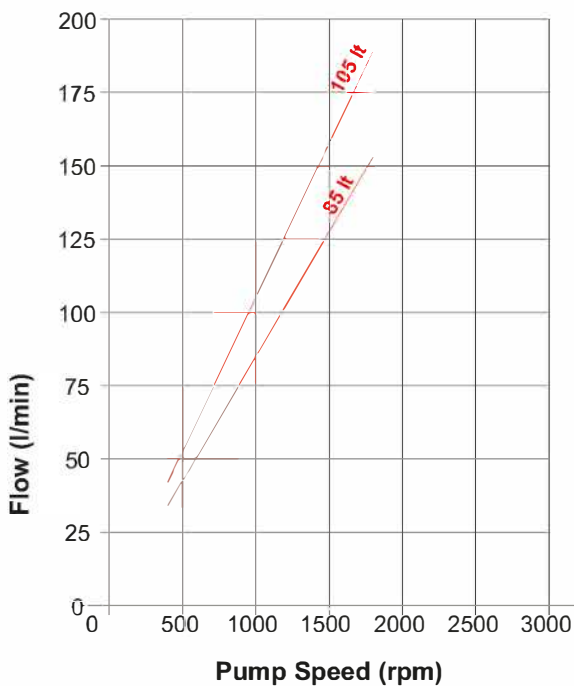
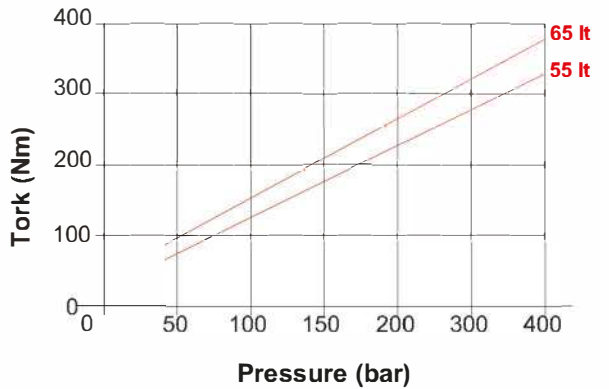

85-105 LT

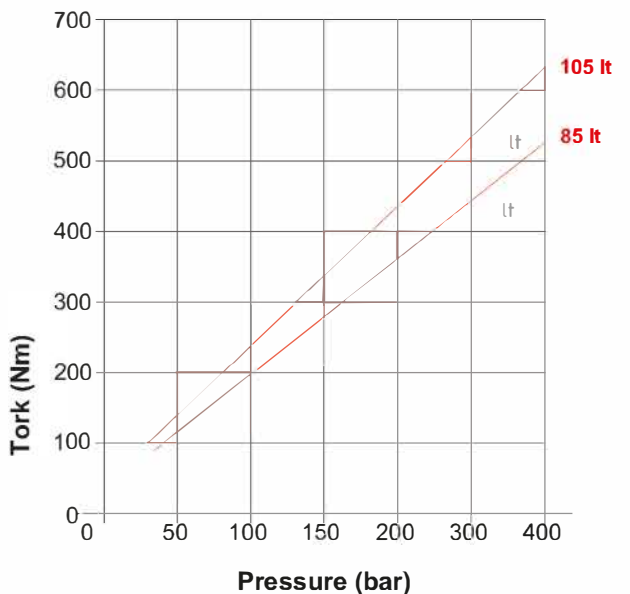



kit kodu	47500008	RAKOR KİTİ 35-45 EKSENEL EĞİK RAKORLU ADAPTER KİT 35-45 lt BENTAXIS 45° ELBOW
alt parçalar sub-assembly	87010014	RAKOR GİRİŞ EĞİK 45° EKSENEL (35-45 LT) SUCTION ADAPTER BENTAXIS 45° ELBOW
	87030170	PUL EKSENEL RAKOR 35-45 LT WASHER FOR BENT AXIS
	99261023	CİVATA ALTI KÖŞE M6x20 (DIN 933) HEXAGON BOLT (ZINC Cr+3)
	99232026	ORİNG 28x2,5
	87090516	KUTU EKSENEL RAKOR KİTİ BASKISIZ BOX FOR BENT AXIS KIT
	87010008	RAKOR ÇIKIŞ R3/4" PERFLEKSLİ - 1 1/16" UN ADAPTER (3/4" BSPOT WITH EO-SEAL - 1 1/16 UN)

kit kodu	47500011	RAKOR KİTİ 35-45 LT EKSENEL DÜZ RAKORLU ADAPTER KİT 35-45 lt BENTAXIS STRAIGHT
alt parçalar sub-assembly	87010091	RAKOR GİRİŞ DÜZ EKSENEL AKB (35-45 LT) SUCTION ADAPTER BENTAXIS STRAIGHT 1 1/4" BSPT
	87030170	PUL EKSENEL RAKOR 35-45 LT WASHER FOR BENT AXIS
	99261023	CİVATA ALTI KÖŞE M6x20 (DIN 933) HEXAGON BOLT (ZINC Cr+3)
	99232026	ORİNG 28x2,5
	87090516	KUTU EKSENEL RAKOR KİTİ BASKISIZ BOX FOR BENT AXIS KIT
	87010008	RAKOR ÇIKIŞ R3/4" PERFLEKSLİ - 1 1/16" UN ADAPTER (3/4" BSPOT WITH EO-SEAL - 1 1/16 UN)

kit kodu	47500007	RAKOR KİTİ 55-65 EKSENEL EĞİK RAKORLU ADAPTER KİT 55-65 lt BENTAXIS 45° ELBOW
alt parçalar sub-assembly	87010006	RAKOR GİRİŞ EĞİK 45° EKSENEL (55-65 LT) SUCTION ADAPTER BENTAXIS 45° ELBOW
	87030181	PUL EKSENEL RAKOR 55-65 LT WASHER FOR BENT AXIS
	99261031	CİVATA ALTI KÖŞE M8x20 (DIN 933) HEXAGON BOLT (ZINC Cr+3)
	99232030	ORİNG 33x3
	87090516	KUTU EKSENEL RAKOR KİTİ BASKISIZ BOX FOR BENT AXIS KIT
	87010008	RAKOR ÇIKIŞ R3/4" PERFLEKSLİ - 1 1/16" UN ADAPTER (3/4" BSPOT WITH EO-SEAL - 1 1/16 UN)

kit kodu	47500010	RAKOR KİTİ 55-65 LT EKSENEL DÜZ RAKORLU ADAPTER KİT 55-65 lt BENTAXIS STRAIGHT
alt parçalar sub-assembly	87010089	RAKOR GİRİŞ DÜZ EKSENEL AKB (55-65 LT) SUCTION ADAPTER BENTAXIS STRAIGHT 1 1/2" BSPT
	87030181	PUL EKSENEL RAKOR 55-65 LT WASHER FOR BENT AXIS
	99261031	CİVATA ALTI KÖŞE M8x20 (DIN 933) HEXAGON BOLT (ZINC Cr+3)
	99232030	ORİNG 33x3
	87090516	KUTU EKSENEL RAKOR KİTİ BASKISIZ BOX FOR BENT AXIS KIT
	87010008	RAKOR ÇIKIŞ R3/4" PERFLEKSLİ - 1 1/16" UN ADAPTER (3/4" BSPOT WITH EO-SEAL - 1 1/16 UN)

kit kodu	47500005	RAKOR KİTİ 85-105 EKSENEL EĞİK RAKORLU ADAPTER KİT 85-105 lt BENTAXIS 45° ELBOW
alt parçalar sub-assembly	87010017	RAKOR GİRİŞ EĞİK 45° EKSENEL (85-105 LT) SUCTION ADAPTER BENTAXIS 45° ELBOW
	87030169	PUL EKSENEL RAKOR 85-105 LT WASHER FOR BENT AXIS
	99261031	CİVATA ALTI KÖŞE M8x20 (DIN 933) HEXAGON BOLT (ZINC Cr+3)
	99232213	ORİNG 46,04x3,53
	87090516	KUTU EKSENEL RAKOR KİTİ BASKISIZ BOX FOR BENT AXIS KIT
	87010115	RAKOR ÇIKIŞ R1" PERFLEKSLİ - 1 5/16" UN ADAPTER (1" BSPOT WITH EO-SEAL - 1 5/16 UN)

kit kodu	47500009	RAKOR KİTİ 85-105 EKSENEL DÜZ RAKORLU ADAPTER KİT 85-105 lt BENTAXIS STRAIGHT
alt parçalar sub-assembly	87010088	RAKOR GİRİŞ DÜZ EKSENEL AKB (85-105 LT) SUCTION ADAPTER BENTAXIS STRAIGHT 2" BSPIT
	87030169	PUL EKSENEL RAKOR 85-105 LT WASHER FOR BENT AXIS
	99261031	CİVATA ALTI KÖŞE M8x20 (DIN 933) HEXAGON BOLT (ZINC Cr+3)
	99232213	ORİNG 46,04x3,53
	87090516	KUTU EKSENEL RAKOR KİTİ BASKISIZ BOX FOR BENT AXIS KIT
	87010115	RAKOR ÇIKIŞ R1" PERFLEKSLİ - 1 5/16" UN ADAPTER (1" BSPOT WITH EO-SEAL - 1 5/16 UN)